

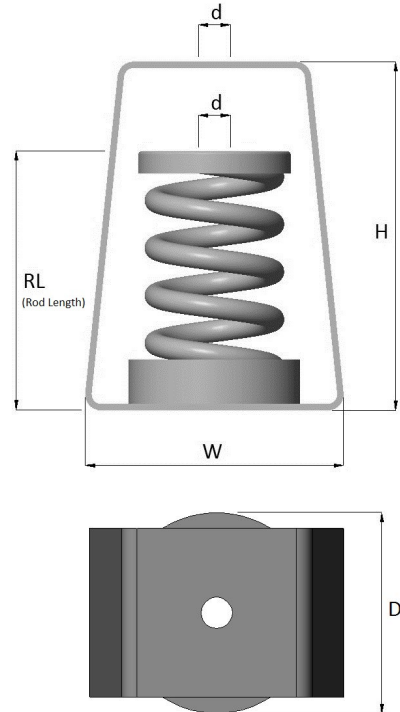

Spring Hanger Range (SH)

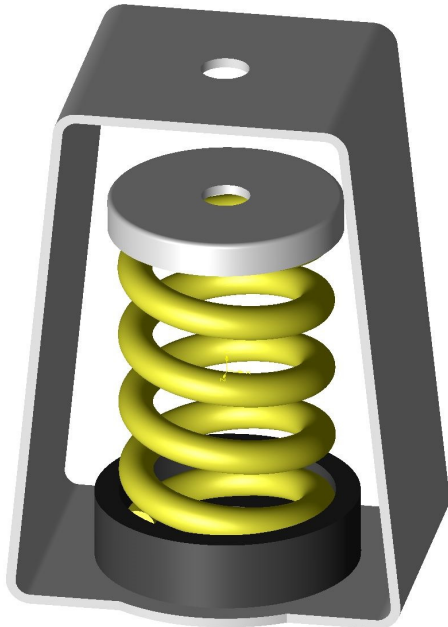

Size	Rated Load (kg)	Rated Defl. (mm)	Spring Rate (kg/mm)	Spring Colour	H	D	RL	d	W
SH1 -	45	20	0.5	Blue	130	50	100	10	83
	75	34	0.9	Orange					
	125	56	1.7	Red					
	200	90	3.1	Black					
	310	150	6.1	Yellow					
SH2 -	60	27	0.5	Grey	180	65	135	12	120
	140	64	1.3	Orange					
	280	128	3.2	Green					
	450	207	6.3	Red					
	750	340	11.3	White					
	1000	450	25	Blue					
SH3 -	225	100	2.2	Blue	190	75	140	16	135
	435	200	5.1	Grey					
	735	320	9.2	White					
	1000	445	17.2	Black					
	1350	615	24.6	Yellow					
	1675	765	30.6	Yellow*					
	2100	950	38	Yellow**					

*grey inner spring **red inner spring