

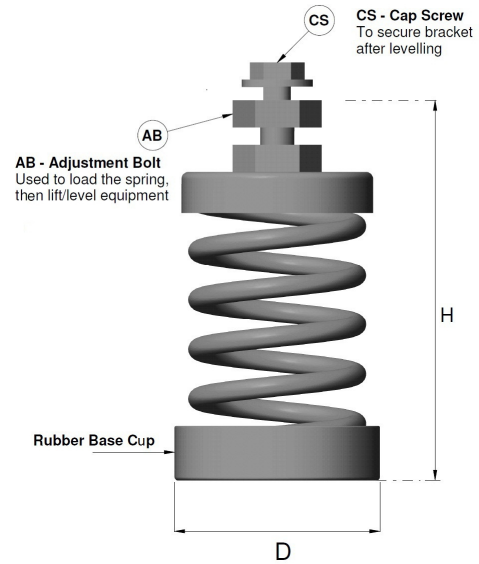

Spring Mount Range

Type SMR

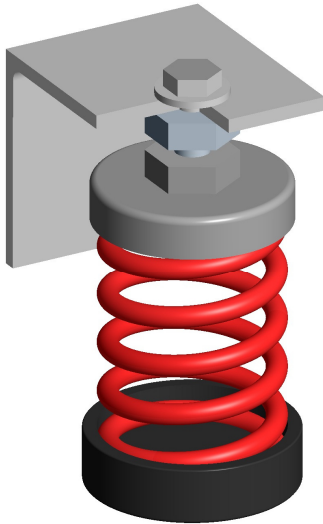

Size		Rated Load (kg)	Rated Defl. (mm)	Spring Rate (kg/mm)	Spring Colour	Free Operating Height H	Adjustment Bolt AB	Cap Screw		Diameter D
								CS		
SMR1	45	20	40	0.5	Blue	107	M16x65	M10x25		54
	75	34	38	0.9	Orange					
	125	56	33	1.7	Red					
	200	90	29	3.1	Black					
	310	150	25	6.1	Yellow					
SMR2	60	27	54	0.5	Grey	150	M20x90	M10x30		70
	140	64	49	1.3	Orange					
	280	128	40	3.2	Green					
	450	207	33	6.3	Red					
	750	340	30	11.3	White					
	1000	450	25	18.0	Blue					
SMR3	110	50	52	0.95	Orange	150	M20x90	M10x30		82
	225	100	45	2.2	Blue					
	435	200	39	5.1	Grey					
	735	320	35	9.2	White					
	1000	445	26	17.2	Black					
	1350	615	25	24.6	Yellow					
	1675	765	25	30.6	Yellow*					
	2100	950	25	38.0	Yellow**					

*grey inner spring **red inner spring